

Sheet 2 Planting Schedule

Plant Name	Height	Girth (cm)	Container	Root	Density	Percentage	Quantity
Bulb							
Amelanchier lamarckii (multi-stem)	125-150cm			B			2
Malus 'Red Sentinel'	300-350cm	10-12cm		RB			2
Tilia cordata 'Green Spire'	300-350cm	10-12cm		RB			1
Herbaceous							
Anemone x hybrida 'September Charm'		3L	C		8.00		27
Calamagrostis x acutiflora 'Karl Foerster'		2L	C		8.00		47
Cephalaria gigantea		3L	C		8.00		15
Deschampsia caespitosa		2L	C		8.00		53
Geum 'Mai Tai'		3L	C		8.00		5
Hakonechloa macroa		2L	C		8.00		34
Hakonechloa macroa 'Nicolas'		2L	C		8.00		72
Kniphofia 'Rufa'		3L	C		8.00		5
Molinia caerulea subsp. arundinacea 'Transparent'		2L	C		8.00		72
Nerine bowdenii		3L	C		8.00		31
Pennisetum setaceum		2L	C		8.00		74
Perovskia atriplicifolia 'Little Spire'		2L	C		8.00		32
Salvia 'Indigo Spires'		3L	C		8.00		13
Sanguisorba officinalis		3L	C		8.00		20
Stipa arundinacea		2L	C		8.00		20
Symphothrichum novi-belgii 'Blue Eyes'		2L	C		8.00		28
Verbena bonariensis		3L	C		8.00		12
Plug							
Digitalis purpurea		9cm	C				27
Knautia arvensis		9cm	C				35
Leucanthemum vulgare		9cm	C				19
Malva moschata		9cm	C				14
Primula veris		9cm	C				41
Primula vulgaris		9cm	C				36
Shrub							
Cistus purpureus 'Alan Fradd'	30-40cm	3-5L	C		6.00		47
Cornus 'Kelsey Dwarf'	40-50cm	3-5L	C		6.00		90
Cytisus 'Lena'	50-60cm	3-5L	C		6.00		38
Euonymus japonicus 'Paloma Blanca'	40-50cm	3-5L	C		6.00		53
Forsythia 'Dwarf Mini Gold'	40-50cm	3-5L	C		6.00		14
Hebe 'Green Globe'	40-50cm	3-5L	C		6.00		36
Lavandula angustifolia 'Hidcote'	25-40cm	3-5L	C		6.00		71
Rosmarinus officinalis	40-50cm	3-5L	C		6.00		29
Specimen Shrub							
Amelanchier lamarckii-Specimen	120-150cm	12-15L	C				3
Hydrangea arborescens 'Annabelle'	80-100cm	12-15L	C				2
Sambucus nigra 'Black Beauty'	100-125cm	12-15L	C				2

Plant Name	Height	Girth (cm)	Container	Root	Density	Percentage	Quantity
Amelanchier lamarckii (multi-stem)	125-150cm			B			2
Malus 'Red Sentinel'	300-350cm	10-12cm		RB			2
Tilia cordata 'Green Spire'	300-350cm	10-12cm		RB			1

Root Condition Abbreviations:
 RB - Root Ball, C - Container Grown, BR - Bare Rooted, B - Bagged
 Bulb Planting: Bulbs to be scattered by hand in designated planting areas and planted where they fall for naturalistic species groupings.
 Seeding Measures: Species Rich Amenity Grass Mix (Emorsgate EL1) 8589m² (34,344g seeding)
 Meadow Mixture for Wetland (Emorsgate EM8) 250m² (1,000g seeding)
 Areas stated above are site wide.

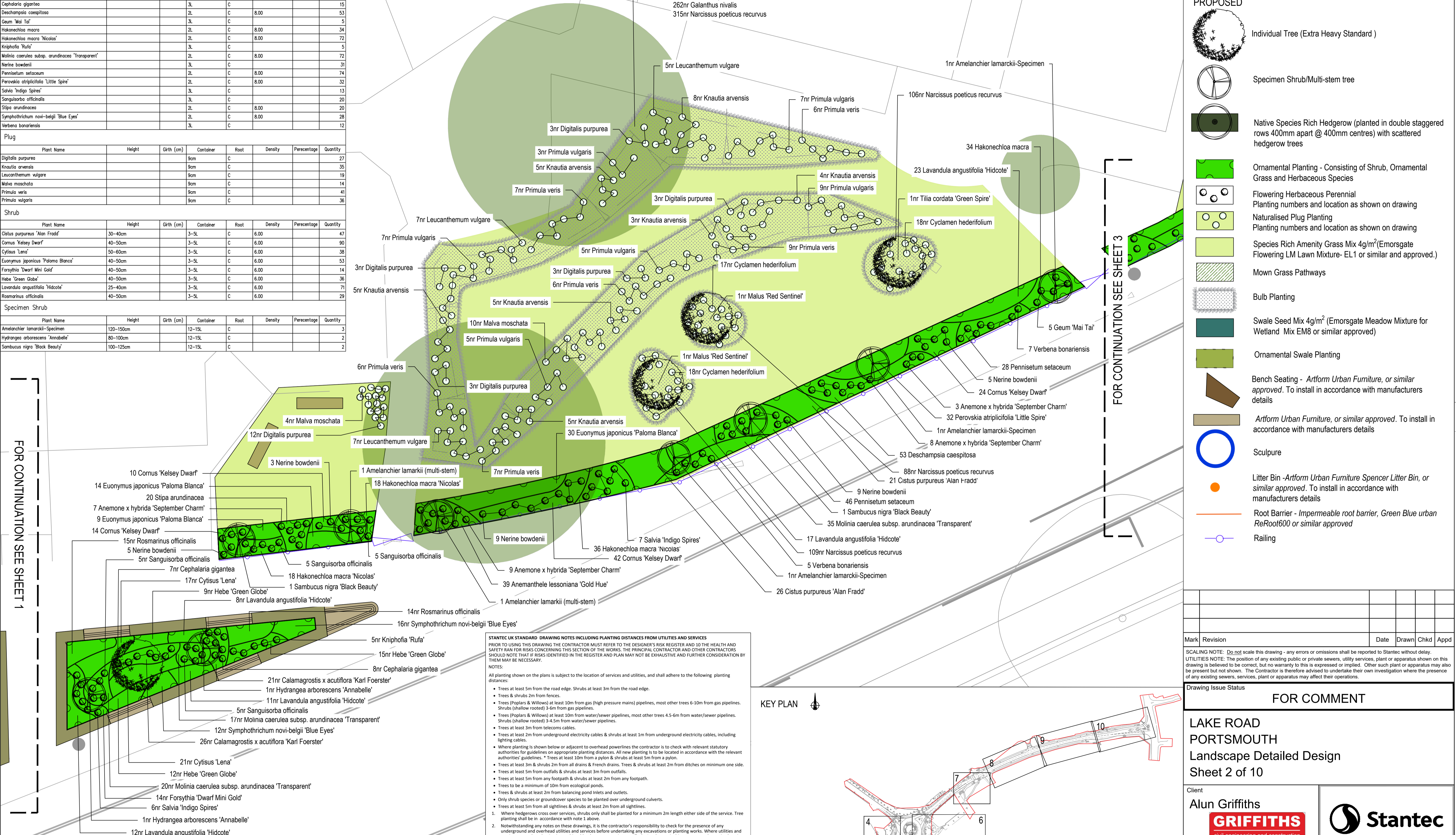

Plant Name	Height	Girth (cm)	Container	Root	Density	Percentage	Quantity
Digitalis purpurea		9cm	C				27
Knautia arvensis		9cm	C				35
Leucanthemum vulgare		9cm	C				19
Malva moschata		9cm	C				14
Primula veris		9cm	C				41
Primula vulgaris		9cm	C				36

FOR CONTINUATION SEE SHEET 1

Plant Name	Height	Girth (cm)	Container	Root	Density	Percentage	Quantity
Cistus purpureus 'Alan Fradd'	30-40cm	3-5L	C		6.00		47
Cornus 'Kelsey Dwarf'	40-50cm	3-5L	C		6.00		90
Cytisus 'Lena'	50-60cm	3-5L	C		6.00		38
Euonymus japonicus 'Paloma Blanca'	40-50cm	3-5L	C		6.00		53
Forsythia 'Dwarf Mini Gold'	40-50cm	3-5L	C		6.00		14
Hebe 'Green Globe'	40-50cm	3-5L	C		6.00		36
Lavandula angustifolia 'Hidcote'	25-40cm	3-5L	C		6.00		71
Rosmarinus officinalis	40-50cm	3-5L	C		6.00		29

FOR CONTINUATION SEE SHEET 3

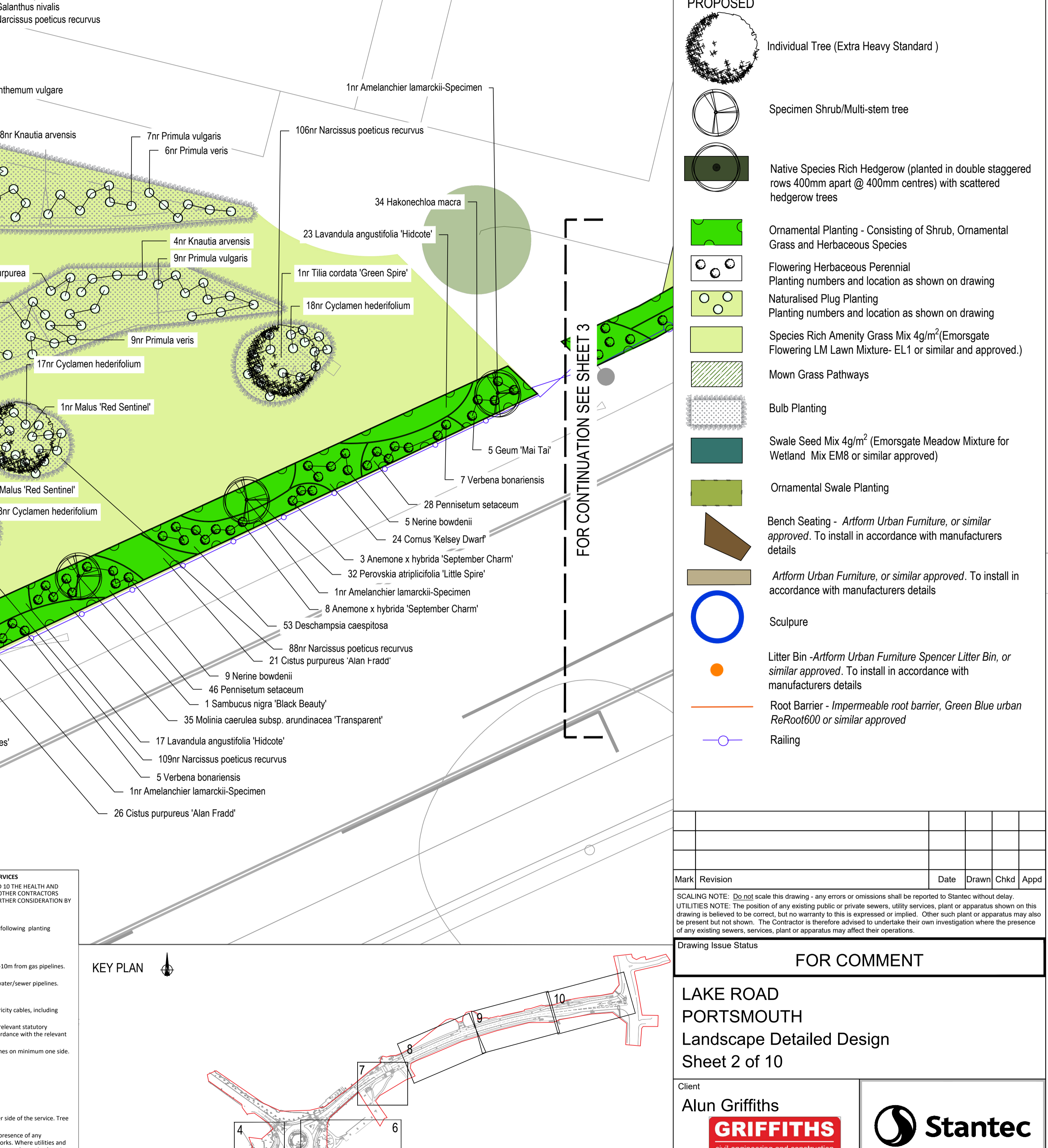

Plant Name	Height	Girth (cm)	Container	Root	Density	Percentage	Quantity
Amelanchier lamarckii-Specimen	120-150cm	12-15L	C				3
Hydrangea arborescens 'Annabelle'	80-100cm	12-15L	C				2
Sambucus nigra 'Black Beauty'	100-125cm	12-15L	C				2

FOR CONTINUATION SEE SHEET 1

LEGEND

EXISTING

- Tree (retained)
- Tree Root Protection Zones

PROPOSED

- Individual Tree (Extra Heavy Standard)
- Specimen Shrub/Multi-stem tree
- Native Species Rich Hedgerow (planted in double staggered rows 400mm apart @ 400mm centres) with scattered hedgerow trees
- Ornamental Planting - Consisting of Shrub, Ornamental Grass and Herbaceous Species
- Flowering Herbaceous Perennial
- Naturalised Plug Planting
- Species Rich Amenity Grass Mix 4g/m² (Emorsgate Flowering LM Lawn Mixture- EL1 or similar and approved.)
- Mown Grass Pathways
- Bulb Planting
- Swale Seed Mix 4g/m² (Emorsgate Meadow Mixture for Wetland Mix EM8 or similar approved)
- Ornamental Swale Planting
- Bench Seating - Artform Urban Furniture, or similar approved. To install in accordance with manufacturers details
- Artform Urban Furniture, or similar approved. To install in accordance with manufacturers details
- Sculpture
- Litter Bin - Artform Urban Furniture Spencer Litter Bin, or similar approved. To install in accordance with manufacturers details
- Root Barrier - Impermeable root barrier, Green Blue urban ReRoot600 or similar approved
- Railing

STANTEC UK STANDARD DRAWING NOTES INCLUDING PLANTING DISTANCES FROM UTILITIES AND SERVICES

PRIOR TO USING THIS DRAWING THE CONTRACTOR MUST REFER TO THE DESIGNER'S RISK REGISTER AND TO THE HEALTH AND SAFETY RISK FOR RISKS CONCERNING THIS SECTION OF THE WORKS. THE PRINCIPAL CONTRACTOR AND OTHER CONTRACTORS SHOULD NOTE THAT IF RISKS IDENTIFIED IN THE REGISTER AND PLAN MAY NOT BE EXHAUSTIVE AND FURTHER CONSIDERATION BY THEM MAY BE NECESSARY.

NOTES:

All planting shown on the plans is subject to the location of services and utilities, and shall adhere to the following planting distances:

- Trees at least 5m from the road edge. Shrubs at least 3m from the road edge.
- Trees & shrubs 2m from fences.
- Trees (Poplars & Willows) at least 10m from gas (high pressure mains) pipelines, most other trees 6-10m from gas pipelines. Shrubs (shallow rooted) 3-6m from gas pipelines.
- Trees (Poplars & Willows) at least 10m from water/sewer pipelines, most other trees 4.5-6m from water/sewer pipelines. Shrubs (shallow rooted) 3-4.5m from water/sewer pipelines.
- Trees at least 3m from telecoms cables.
- Trees at least 2m from underground electricity cables & shrubs at least 1m from underground electricity cables, including lighting cables.
- Where planting is shown below or adjacent to overhead powerlines the contractor is to check with relevant statutory authorities for guidelines on appropriate planting distances. All new planting is to be located in accordance with the relevant authorities' guidelines. * Trees at least 10m from a pylon & shrubs at least 5m from a pylon.
- Trees at least 3m & shrubs 2m from all drains & French drains. Trees & shrubs at least 2m from ditches on minimum one side.
- Trees at least 5m from outfalls & shrubs at least 3m from outfalls.
- Trees at least 5m from any footpath & shrubs at least 2m from any footpath.
- Trees to be a minimum of 10m from ecological ponds.
- Trees & shrubs at least 2m from balancing pond inlets and outlets.
- Only shrub species or groundcover species to be planted over underground culverts.
- Trees at least 5m from all sightlines & shrubs at least 2m from all sightlines.

- Where hedgerows cross over services, shrubs only shall be planted for a minimum 2m length either side of the service. Tree planting shall be in accordance with note 1 above.
- Notwithstanding any notes on these drawings, it is the contractor's responsibility to check for the presence of any underground and overhead utilities and services before undertaking any excavations or planting works. Where utilities and services mean that planting is unachievable, the contractor is to notify the Landscape Architect to agree alternative locations.
- Refer to the Landscape Planting and Maintenance Specification.
- Refer to the plant schedule for details of plant mixes.
- All soft areas shall be grass seeded as set out in the detailed design. Refer to the plant specification for subsoil and topsoil requirements and treatment of areas prior to planting.
- Site setting out of landscape areas and planting shall be to the acceptance of the Landscape Clerk of Works or Project Landscape Architect.
- This drawing should be read in conjunction with all relevant drawings, standard earthworks details, structures, surface drainage, pre-earthworks drainage, utilities drawings, lighting and signage drawings. All relevant landscape and earthworks specifications as set out in notes 4 to 6 above.
- All planting to be within the site boundary.
- Refer to individual plots on the drawing for details of plant centres where plot is less than 5m wide.

Mark	Revision	Date	Drawn	Chkd	Appd

SCALING NOTE: Do not scale this drawing - any errors or omissions shall be reported to Stantec without delay.
 UTILITIES NOTE: The position of any existing public or private sewers, utility services, plant or apparatus shown on this drawing is believed to be correct, but no warranty to this is expressed or implied. Other such plant or apparatus may also be present but not shown. The Contractor is therefore advised to undertake their own investigation where the presence of any existing sewers, services, plant or apparatus may affect their operations.

Drawing Issue Status **FOR COMMENT**

LAKE ROAD PORTSMOUTH
 Landscape Detailed Design
 Sheet 2 of 10

Client
Alun Griffiths
GRIFFITHS
 civil engineering and construction

Stantec
 stantec.com/uk

Date of 1st Issue: 13.10.22
 Designed: KH/KM
 Drawn: KM

A1 Scale 1:100
 Checked: KH
 Approved: AC

Drawing Number: 49903_3000_102
 Revision: -

BRISTOL
 Tel: 01173 327 840